

AC Power LM100 Drapery Motor Instruction

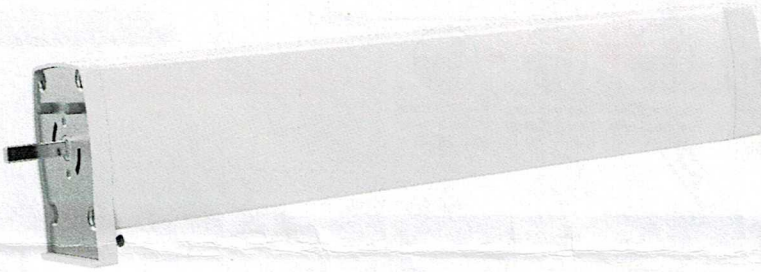

Functions and Features

Soft and super silent design

Super silent design, the noise is as low as 30dbs in operating. Leading intelligent design, which makes the curtain running soft start and stop like an advanced elevator, lissome and quiet.

Auto set limit journey

Auto set and remember the best stop positions to protect the parts not being noisy or damaged by crash and keep the system with long life. Able to keep the limits journey when the power off.

Light-touch function

Motor in the power on state, the curtain could open or close automatically when move the curtain fabric about 5CM in one direction.

Limit correction

The curtain motor will auto remember the stop position after rebound as a new limit position when fabric being extruded and rebounded, lead to fabric stops at an ideal and nicer position.

Manually operation

Able to manually open or close the curtain when the power off.

Multiple connections

Standard interface support multiple motors connections, and can be controlled by external switch or central control.

Stop on block

The curtain stops automatically when it's pulleys meet resistance to protect the whole system not being damaged.

Adjustable speed

Able to adjust motor speed according to the requirements.

Various control modes

Various controls modes to service different applications. (RF control, Cable switch, RS232/485, etc.)

Parameters

Model no	Rated torque	Speed	Motor size	Rated voltage	Rated power	IP level
LM100	1.2N-m	12cm/s	345x58x50mm	AC100-240V 50/60Hz	65W	IP20

Loading diagram

Track length	Track and pulley		R3000		R3600		R3000	
	Single motor with double pulley	Single motor with single pulley	Single motor with double pulley	Single motor with single pulley	Single motor with double pulley	Single motor with single pulley	Single motor with double pulley	Single motor with single pulley
4m	90kg	75kg	67.5kg	60kg	52.5kg	45kg	46.5kg	31.5kg
8m	82.5kg	67.5kg	60kg	52.5kg	45kg	37.5kg	31.5kg	24kg
12m	75kg	60kg	52.5kg	45kg	37.5kg	30kg		

Structure and accessories

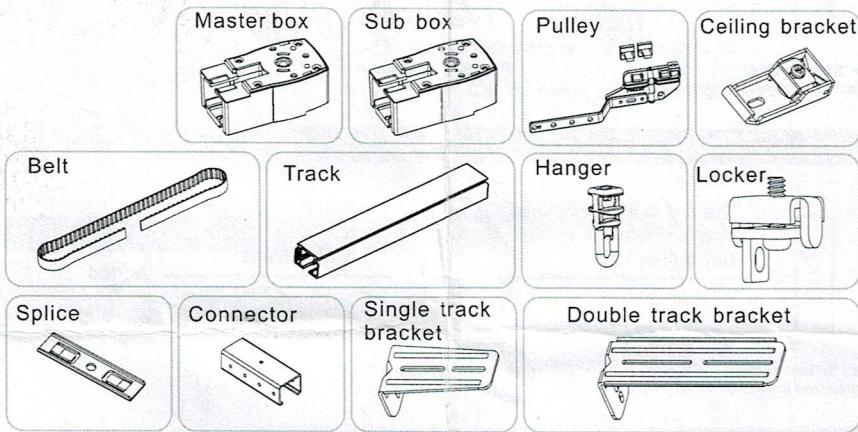
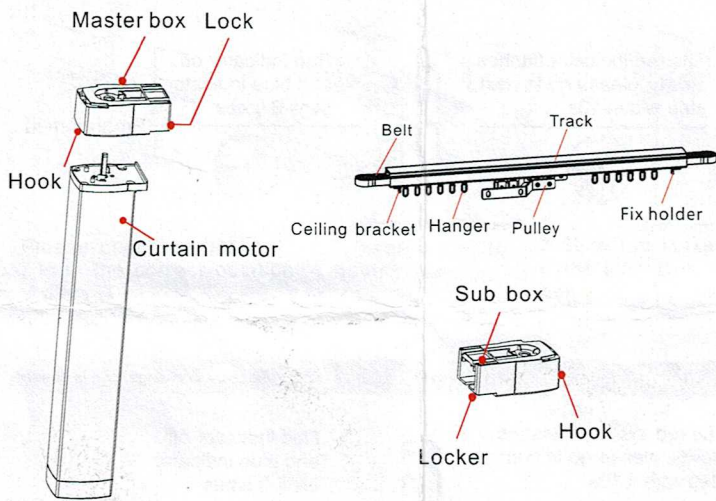

Installation

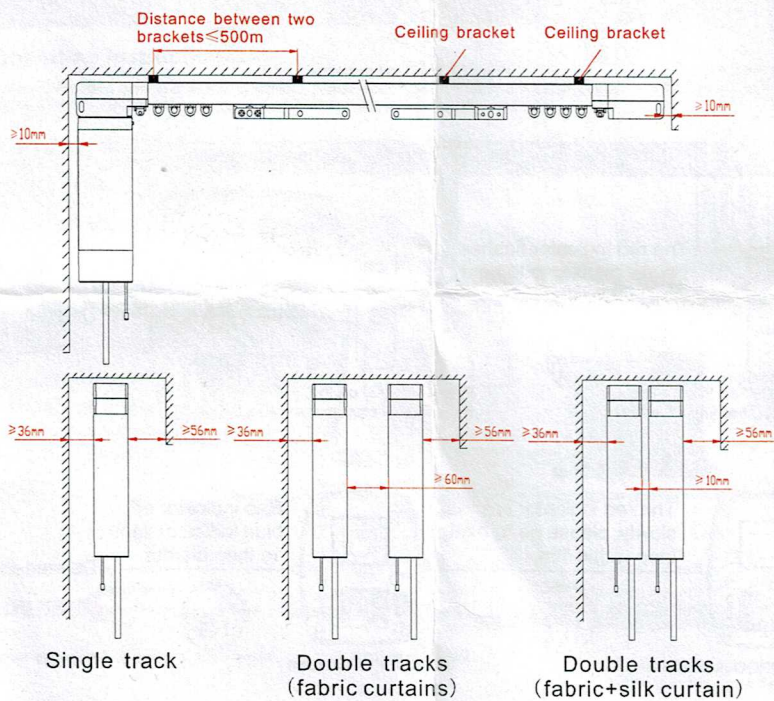

Curtain motor control modes

Single/double pulley

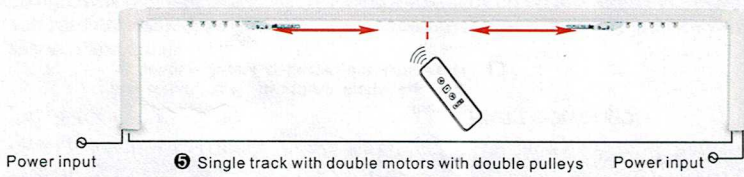
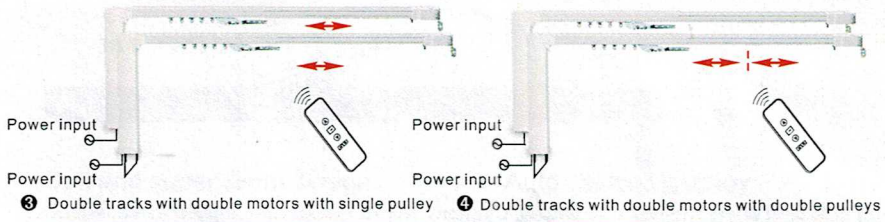
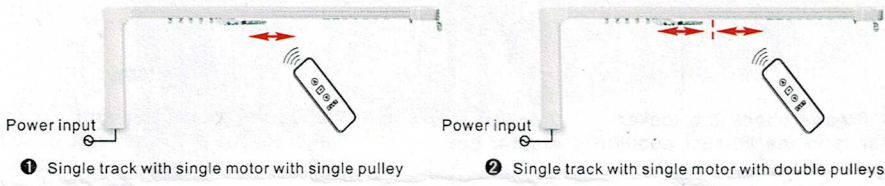

Control mode

RF control + pulse switch - separate control and group control solution

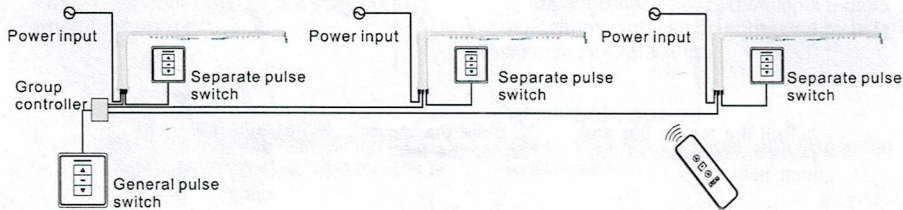

RF separate control and group control solution

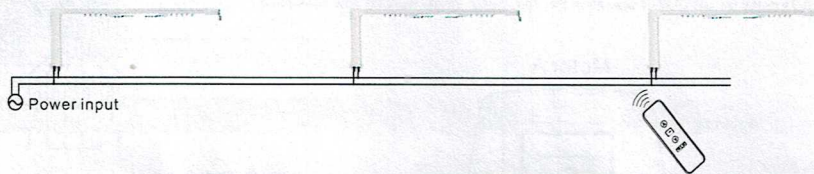

Computer control and group control solution

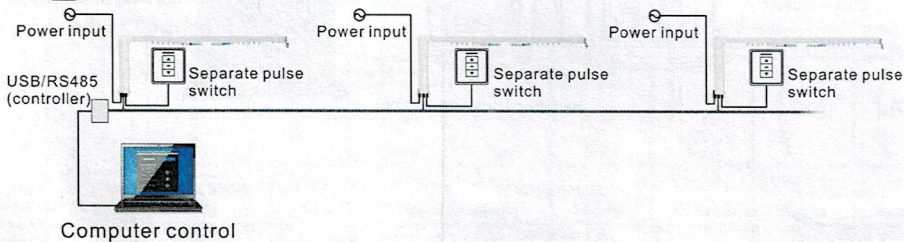

Motor installation

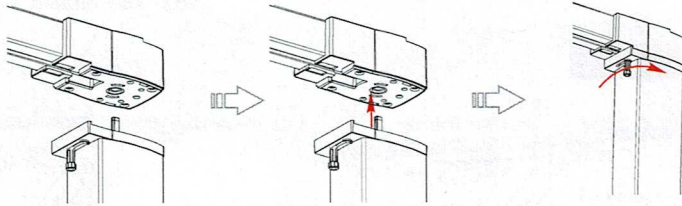

1. Please check the locker bar is in the correct position as image

2. Insert motor to master box

3. Slide the locker bar and make sure it is in the limit hole

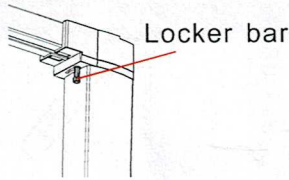

Caution

- Please follow the above dimensions for installation
- Make sure the locker bar in the position as image
- Make sure the ceiling is strong enough to bear the whole weight of track, motor and curtain

Motor removable

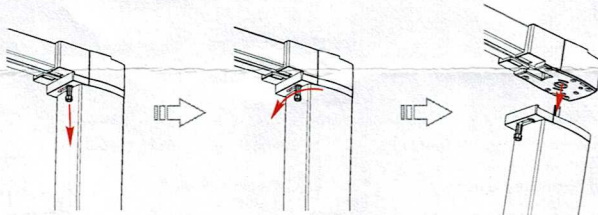

1. Pull the locker bar and make it move out of the limit hole

2. Slide the locker bar to the left

3. Remove the motor

Wiring

Operation instruction

- If the transmitter is multi-channel transmitter, please select channel firstly before operation
- 0.5s delay for UP/DOWN operation transfer, motor single working time max 5min

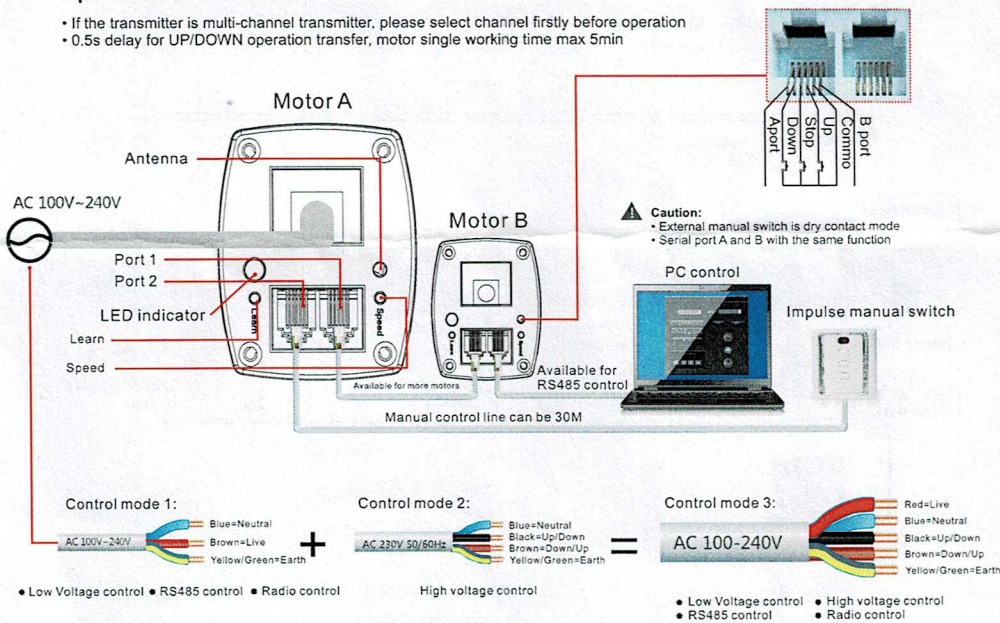

1 Programming

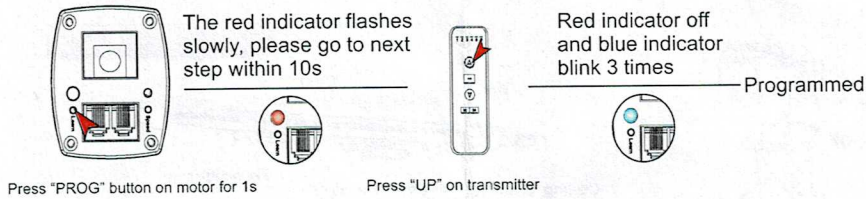

2 Direction changing

If motor moves in correct direction, it is not necessary to change, or it is needed.

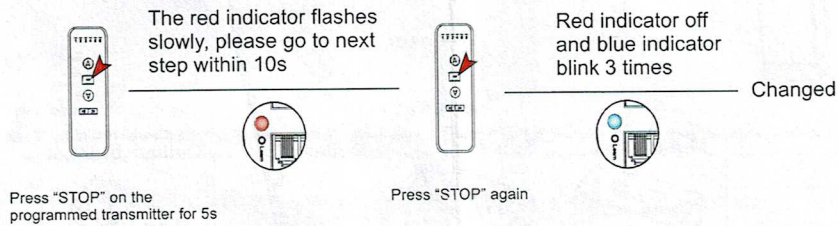

3 Adding new transmitter

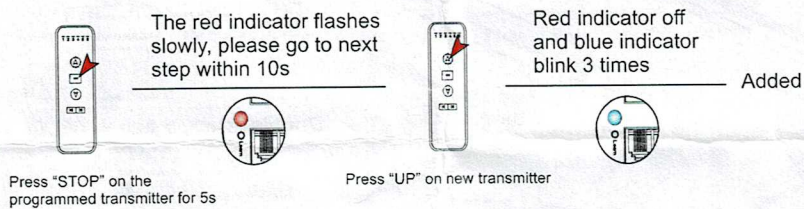

4 Single code deleting

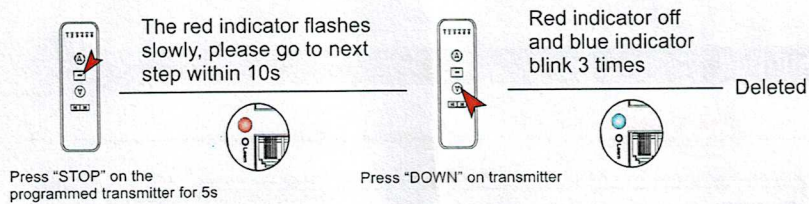

5 All codes deleting

Journey will be deleted after deleting all codes

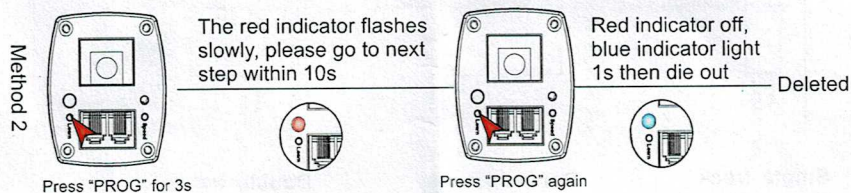
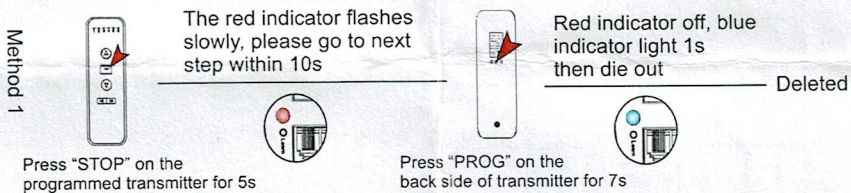

6 Light Touch-start function on/off transferring **Light Touch-start function instruction:** lightly pull the fabric to 5cm, the curtain will be open or close automatically

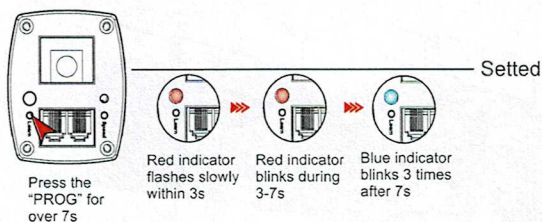

7 Highest speed setting

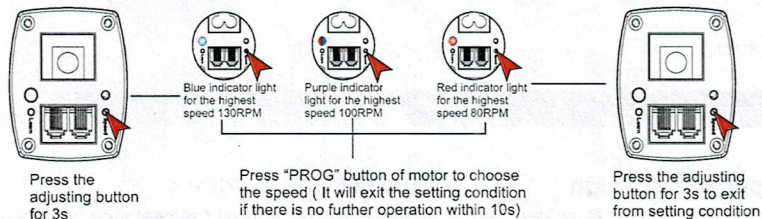

LED status instruction:
Under the working condition, LED light for current highest running speed, red for 50-80RPM, purple for 81-100RPM, blue for 101-130RPM

8 Limit position fine tuning After enter limit position fine tuning condition, motor has no light touch-start function, it is available for moving to expected position by manually.

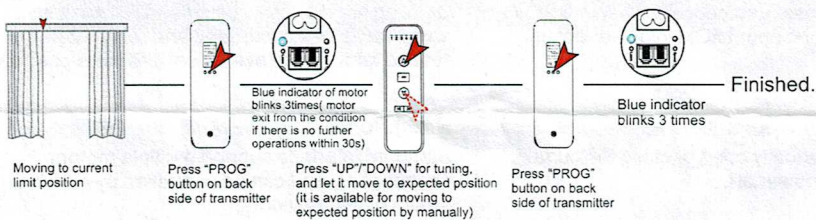

Warranty

- 1、 5 years warranty of the motor , while artificial damage of damage arising from unauthorized disassembly are excluded.
- 2、 3 years warranty of the control system ,while artificial damage of damage arising from unauthorized disassembly are excluded.
- 3、 Accessories will be entitled to freerepair for 1 year ,while artificial damage of damage arising from unauthorized disassembly are excluded.
- 4、 Please contact your local dealer for after-sale services.